

ELECTRIC LONG HAND PLANER CE24E - 445MM



€502,04 (excl. VAT)

This Virutex electric hand planer is equipped with a base plate with a length of 442 mm. The singlepiece housing is made entirely of aluminium. It is therefore a very sturdy and robust tool that is at the same time lightweight and easy to handle. Perfectly suited for heavy-duty work with the highest quality standards. With a power output of 1,200 W, the CE242E can carry out the toughest and most demanding tasks. Exhaust installed on the right side. Standard delivery in a handy PVC case with a set of reversible knives.

Optionally available: a guide for even more precise work and a base for stationary use of the CE24E.

SKU: VIR-CE24E

GALERIJAFBEELDINGEN

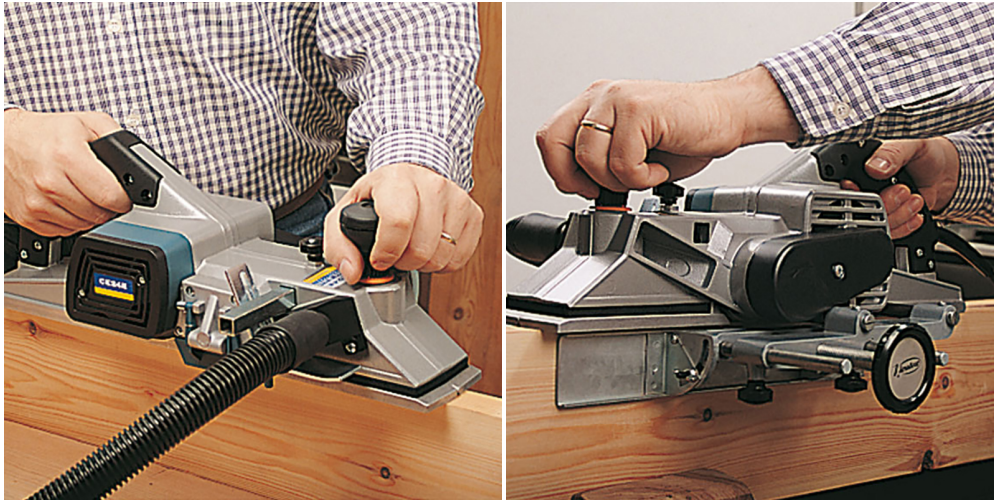

This Virutex electric hand planer is equipped with a base plate with a length of 442 mm. The singlepiece housing is made entirely of aluminium. It is therefore a very sturdy and robust tool that is at the same time lightweight and easy to handle. Perfectly suited for heavy-duty work with the highest quality standards. With a power output of 1,200 W, the CE242E can carry out the toughest and most demanding tasks. Exhaust installed on the right side. Standard delivery in a handy PVC case with a set of reversible knives.

Optionally available: a guide for even more precise work and a base for stationary use of the CE24E.

PRODUCT INFORMATION

- Long hand planer (445mm)
 - Exhaust on the right
 - Robust and light
- For high quality heavy-duty work

DESCRIPTION

This Virutex electric hand planer is equipped with a base plate with a length of 442 mm. The singlepiece housing is made entirely of aluminium. It is therefore a very sturdy and robust tool that is at the same time lightweight and easy to handle. Perfectly suited for heavy-duty work with the highest quality standards. With a

power output of 1,200 W, the CE242E can carry out the toughest and most demanding tasks. Exhaust installed on the right side. Standard delivery in a handy PVC case with a set of reversible knives. Optionally available: a guide for even more precise work and a base for stationary use of the CE24E.

No video available for this product!

DOWNLOADS

No download available.

ADDITIONAL INFORMATION

Weight	6 kg
Input Power	1200W
Cutting depth	0-3mm
Planing width	80mm
Maximum planing depth	25mm
No-load speed	13100rpm