

## ORBITAL SANDER LRE46L WITH ELECTRONIC CONTROL



**€291,83 (excl. VAT)**

Identical to model LR46L but with electronic speed control. Powerful, orbital sander designed for polishing or sanding work with a high-quality finish. The LR46L is well-balanced and delivers high quality work, without the need for touching up afterwards. The standard mounted PUR base plate is virtually unbreakable and allows the installation of any standard sanding paper. Optionally, a base plate with Velcro is available. Thanks to its ergonomic design with front handle and integrated anti-slip surfaces, this machine is very comfortable to work with. And that for both right- and left-handed people.

Finally, this orbital sander is equipped with a new and unique dust protection system. This is to prevent dust from damaging the vulnerable parts. As standard, the LR46L is equipped with an integrated dust extractor and dust bag. Thanks to this improved protection against dust and dust accumulation, both your machine and your sanding paper will last longer than a classic orbital sander.

**SKU:** VIR-LRE46L

## GALERIJAFBEELDINGEN

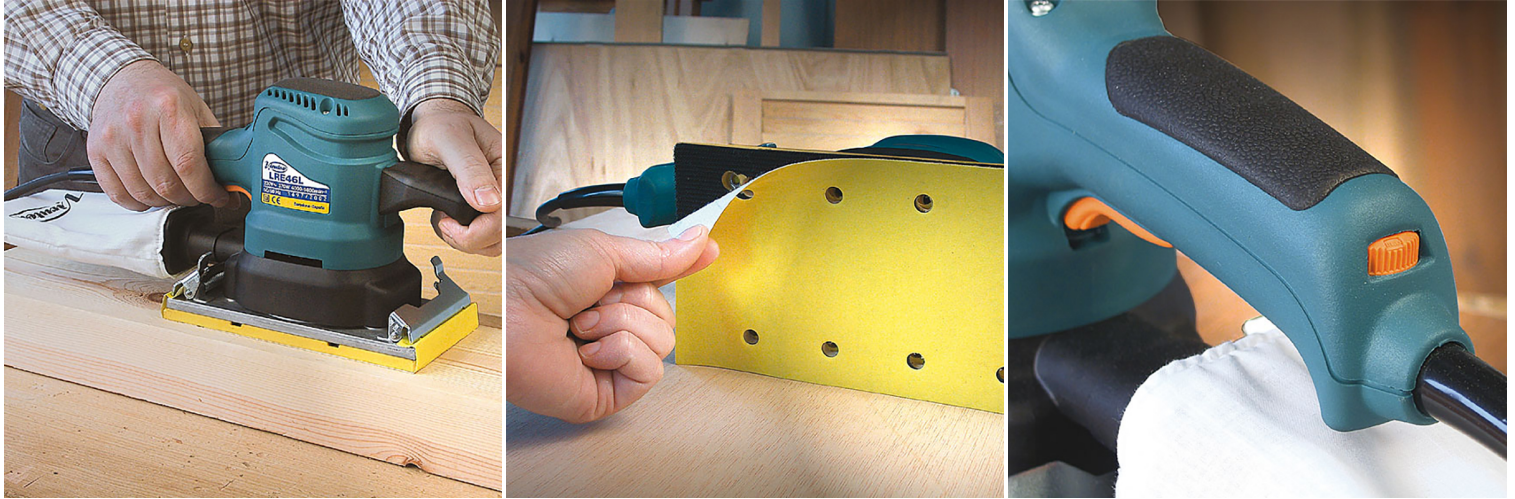

Identical to model LR46L but with electronic speed control. Powerful, orbital sander designed for polishing or sanding work with a high-quality finish. The LR46L is well-balanced and delivers high quality work, without the need for touching up afterwards. The standard mounted PUR base plate is virtually unbreakable and allows the installation of any standard sanding paper. Optionally, a base plate with Velcro is available. Thanks to its ergonomic design with front handle and integrated anti-slip surfaces, this machine is very comfortable to work with. And that for both right- and left-handed people.

Finally, this orbital sander is equipped with a new and unique dust protection system. This is to prevent dust from damaging the vulnerable parts. As standard, the LR46L is equipped with an integrated dust extractor and dust bag. Thanks to this improved protection against dust and dust accumulation, both your machine and your sanding paper will last longer than a classic orbital sander.

## PRODUCT INFORMATION

- Orbital sander
- Velcro plate or plate with clamps
- Improved protection against dust

- Ergonomic design
- High-quality end result
- Electronic speed control

### DESCRIPTION

Identical to model LR46L but with electronic speed control. Powerful, orbital sander designed for polishing or sanding work with a high-quality finish. The LR46L is well-balanced and delivers high quality work, without the need for touching up afterwards. The standard mounted PUR base plate is virtually unbreakable and allows the installation of any standard sanding paper. Optionally, a base plate with Velcro is available. Thanks to its ergonomic design with front handle and integrated anti-slip surfaces, this machine is very comfortable to work with. And that for both right- and left-handed people. Finally, this orbital sander is equipped with a new and unique dust protection system. This is to prevent dust from damaging the vulnerable parts. As standard, the LR46L is equipped with an integrated dust extractor and dust bag. Thanks to this improved protection against dust and dust accumulation, both your machine and your sanding paper will last longer than a classic orbital sander.

No video available for this product!

### DOWNLOADS

No download available.

### ADDITIONAL INFORMATION

<b>Weight</b>	3 kg
<b>Input Power</b>	370W
<b>Working surface</b>	115x208mm
<b>Ø Orbit</b>	2mm
<b>No-load speed</b>	4000-9800rpm
<b>Vibrations</b>	8000-19600/min