

PIHER - TGA QUICK AUTOMATIC CLAMP FOR WELDING TABLES AND WORKBENCHES





€60,96 - €70,16 (excl. VAT)

The TGA clamps, made of stainless steel, are available for Ø16 and 28 mm holes. Epoxy-coated handles, cataphoresis-coated pressure arm, and copper-plated swivel head prevent dirt from welding. Release with one click. M6 threaded hole for accessories. Rear screw controls power. Auto-Adjust technology always applies the set pressure, regardless of height or shape of pieces to be clamped. Clamps workpieces up to 200 mm thick.

SKU: TGA

VARIATIONS

Image	SKU	Description	diameter	Price
-------	-----	-------------	----------	-------

Image	SKU	Description	diameter	Price
	PIH-53122		Ø 16 mm	€60,96 (excl. VAT)
	PIH-53123		Ø 28 mm	€70,16 (excl. VAT)

**GALERIJAFBEELDINGEN**

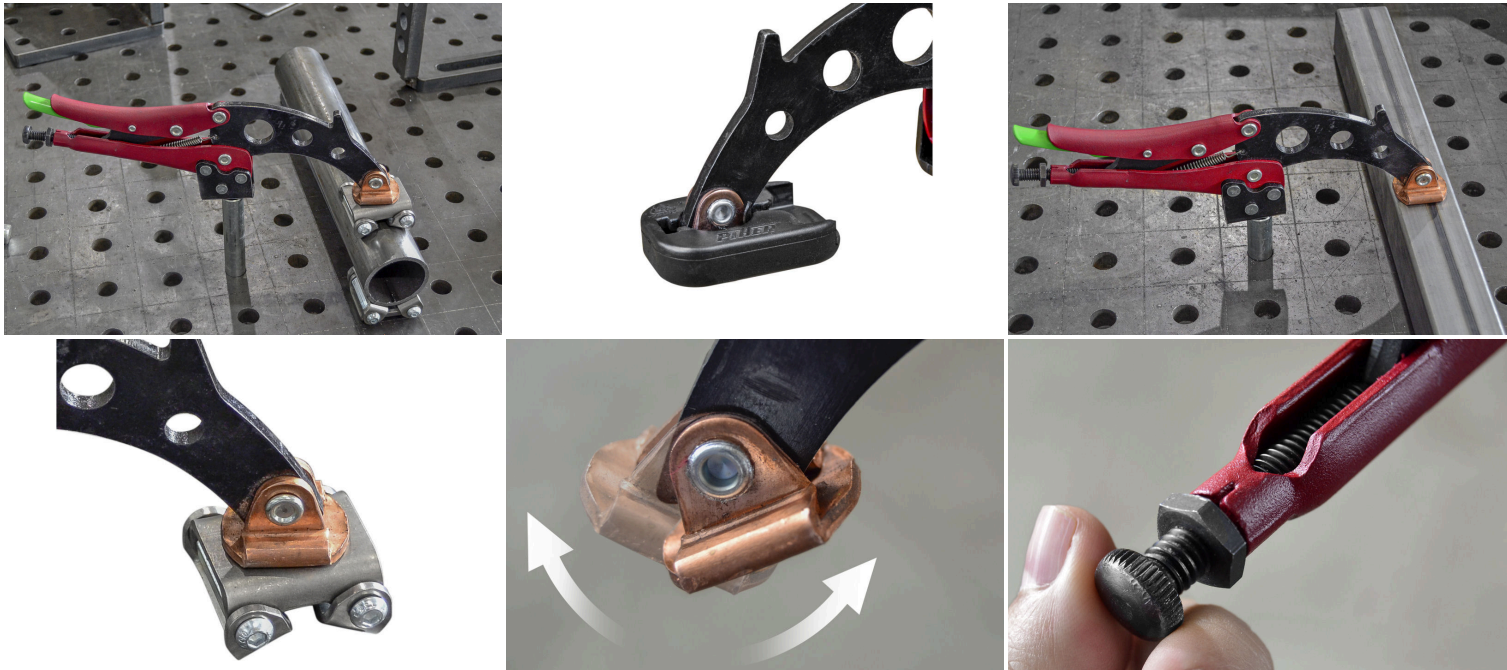

The TGA clamps, made of stainless steel, are available for Ø16 and 28 mm holes. Epoxy-coated handles, cataphoresis-coated pressure arm, and copper-plated swivel head prevent dirt from welding. Release with one click. M6 threaded hole for accessories. Rear screw controls power. Auto-Adjust technology always applies the

set pressure, regardless of height or shape of pieces to be clamped. Clamps workpieces up to 200 mm thick.

### PRODUCT INFORMATION

- TGA clamps made of stainless steel.
- Available for Ø16 and 28 mm holes.
  - Handles coated with epoxy paint.
- Pressure arm coated with cataphoresis.
- Swivel head copper-plated to prevent dirt during welding.
  - Release with one click.
- M6 threaded hole for attaching accessories.
  - Rear screw controls power.
- Auto-Adjust technology always applies the set pressure, regardless of the height or shape of pieces to be clamped.
- Clamps workpieces up to 200 mm thick.
  - 150 kg clamping force

### DESCRIPTION

The TGA clamps, made of stainless steel, are available for Ø16 and 28 mm holes. Epoxy-coated handles, cataphoresis-coated pressure arm, and copper-plated swivel head prevent dirt from welding. Release with one click. M6 threaded hole for accessories. Rear screw controls power. Auto-Adjust technology always applies the set pressure, regardless of height or shape of pieces to be clamped. Clamps workpieces up to 200 mm thick.

No video available for this product!

### DOWNLOADS

No download available.

### ADDITIONAL INFORMATION

<b>Weight</b>	1 kg
<b>Maximum clamping thickness</b>	20cm

<b>Clamping depth</b>	10cm
<b>Diameter</b>	Ø 16 mm, Ø 28 mm