

PNEUMATIC DRILLING MACHINE FOR LINE BORING LINE DRILLER TT21EBM1



€6 .200,00 (excl. VAT)

The Line Driller TT21EBM1 is a drilling machine for line boring with a 1,5 HP induction motor, 1 drill chuck with 21 spindles and pneumatic operation.

SKU: REBO21EBM1

GALERIJAFBEELDINGEN

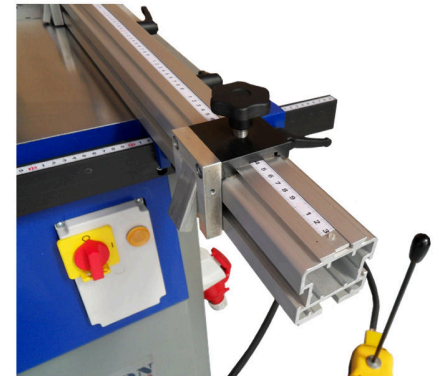
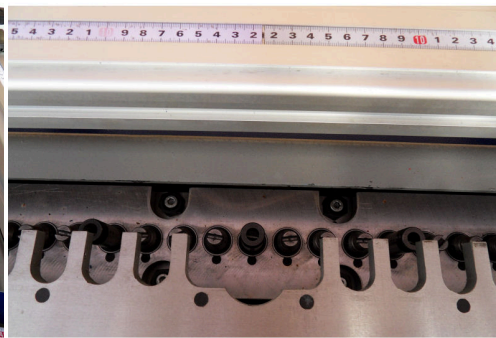
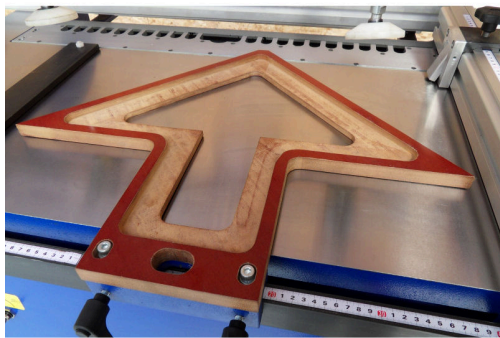
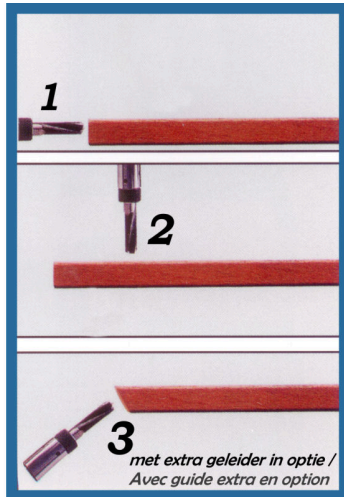

The Line Driller TT21EBM1 is a drilling machine for line boring with 1 drill chuck with 21 spindles and pneumatic operation.

The machine has a powerful 1.5 HP induction motor with a module of 21 bores at a time, each with a spacing of 32 mm.. The aluminum guides are equipped with 4 handy quick stops. The machine has a stable work table of 1090 x 620 mm and is equipped with pneumatic clamping (by means of 2 springs with nylon pressers) with possibility to adjust the pressure. It can be used vertically for line boring and horizontally for dowel boring, and tilted 45° for mitered connections with pins. As a standard, the machine comes with 5 quick-change chucks, and it has a cover and extraction outlet.

Optionally, an easy-to-install module (adapter) for hinge boring (Blum, Hettich, Salice, Grass, Mepla, Mini, Maxi) is also available.

PRODUCT INFORMATION

- Powerful 1,5 HP induction motor
- Rotation speed of spindle: 2800 rpm
- Pneumatic operation with pedal
- Pneumatic clamping with possibility to adjust the pressure (max. 6.5 bar)
 - 21-spindle module (11 right-turning + 10 left-turning)
 - Aluminum guides, equipped with 4 handy quick stops
 - Easy-to-assemble module for hinge boring
 - Large work surface (1090 x 620 mm)
 - The machine comes with **5** quick-change chucks as a standard
 - The machine is supplied **without** the adapter for hinge boring
- Adapter for hinge boring (Blum, Hettich, Salice, Grass, Mepla, Mini, Maxi) (**optional**)
 - Boring depth up to 32 mm - Distance between first and last borehole: 704 mm

DESCRIPTION

The Line Driller TT21EBM1 is a drilling machine for line boring with 1 drill chuck with 21 spindles and pneumatic operation. The machine has a powerful 1.5 HP induction motor with a module of 21 bores at a time, each with a spacing of 32 mm.. The aluminum guides are equipped with 4 handy quick stops. The machine has a stable work table of 1090 x 620 mm and is equipped with pneumatic clamping (by means of 2 springs with nylon pressers) with possibility to adjust the pressure. It can be used vertically for line boring and horizontally for dowel boring, and tilted 45° for mitered connections with pins. As a standard, the machine comes with 5 quick-change chucks, and it has a cover and extraction outlet. Optionally, an easy-to-install module (adapter) for hinge boring (Blum, Hettich, Salice, Grass, Mepla, Mini, Maxi) is also available.

No video available for this product!

DOWNLOADS

No download available.

ADDITIONAL INFORMATION

Weight	375 kg
Dimensions	1000 × 1400 × 1400 cm
Worktable	1090 x 620 mm
Line boring	21 spindles (32 mm apart)
Boring depth	Up to 32 mm
Motor	1.5 HP