

WINDOW FRAME SAWING MACHINE RV70U



€1 .009,95 (excl. VAT)

Virutex's RV70U window frame sawing machine has been developed specifically for sawing wooden frames and for use in restorations. The machine makes slots in wood, but also in other building materials, making it easier to replace window frames. This sawing machine comes standard with a carbide saw blade with 30 teeth and a diamond saw blade to make slots in harder materials. Combined with the strongest motor of its kind (1700W), this sawing machine allows you to replace window frames neatly in any situation and without any problems. By reversing the base of the machine it is also possible to make slots in corners. Max depth of cut 68mm.

SKU: VIR-RV70U

GALERIJAFBEELDINGEN

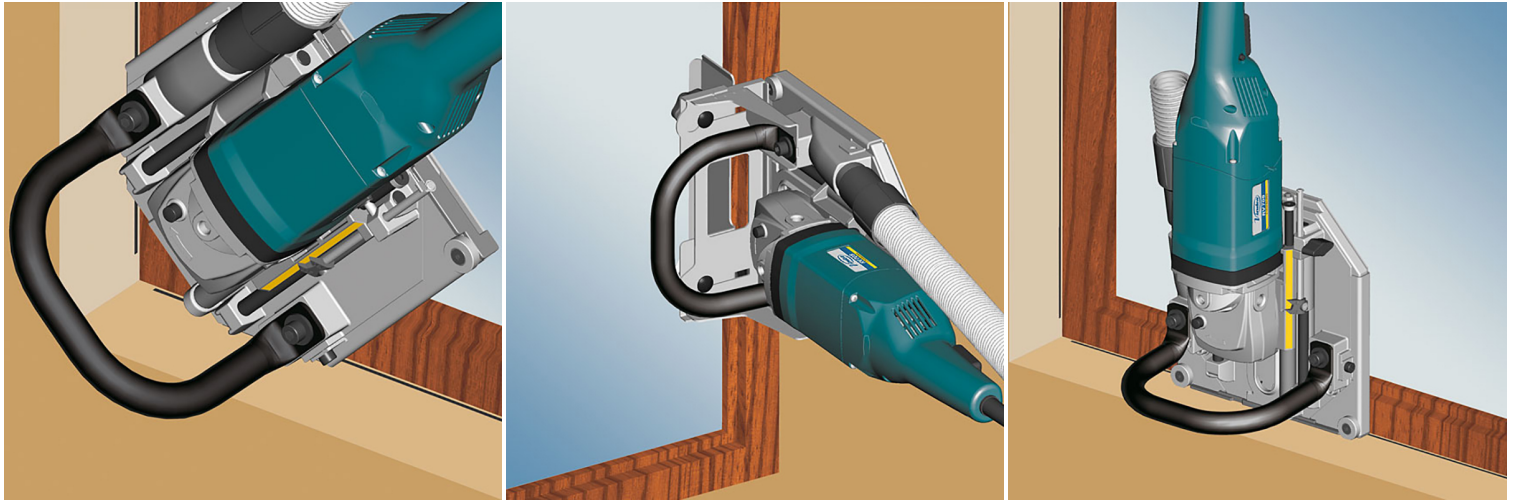

Virutex's RV70U window frame sawing machine has been developed specifically for sawing wooden frames and for use in restorations. The machine makes slots in wood, but also in other building materials, making it easier to replace window frames. The machine is equipped with a special saw blade with 30 tungsten carbide teeth and an adjustable front guide. This guide also serves as a support while working. This sawing machine comes standard with a carbide saw blade with 30 teeth and a diamond saw blade to make slots in harder materials.

Combined with the strongest motor of its kind (1700W), this sawing machine allows you to replace window frames neatly in any situation and without any problems. By reversing the base of the machine it is also possible to make slots in corners. The machine allows you to maintain the original dimensions of the opening and to replace window frames without breaking.

PRODUCT INFORMATION

- Window frame cutting machine
 - Powerful motor (1700W)
- Tungsten carbide and diamond saw blade
 - Deep cut (68mm)
- Replace window frames without demolishing

DESCRIPTION

Virutex's RV70U window frame sawing machine has been developed specifically for sawing wooden frames and for use in restorations. The machine makes slots in wood, but also in other building materials, making it easier to replace window frames. The machine is equipped with a special saw blade with 30 tungsten carbide teeth and an adjustable front guide. This guide also serves as a support while working. This sawing machine comes standard with a carbide saw blade with 30 teeth and a diamond saw blade to make slots in harder materials. Combined with the strongest motor of its kind (1700W), this sawing machine allows you to replace window frames neatly in any situation and without any problems. By reversing the base of the machine it is also possible to make slots in corners. The machine allows you to maintain the original dimensions of the opening and to replace window frames without breaking.

No video available for this product!

DOWNLOADS

ADDITIONAL INFORMATION

Weight	6,6 kg
Input Power	1800W
Height of cut from the base	7mm
Max. depth of cut HW saw blade	68mm
Max. depth of cut diamond sawblade	58mm
No-load speed	6500rpm